

Create and reflect

Track and feedback

Review and assess



*"Through our research
there is clear evidence
that MAPS tools
empower teachers and
learners"*

Professor Richard Kimbell,
Goldsmiths, University of
London



*"It really was just a 5 or
10 minute initial look at
it and then we left it up
to the students"*



*"We have no hesitation in
recommending MAPS for
any school... there is no
better ePortfolio assessment
system on the market"*

Steve Pace
Learning Technologies
Advisory Teacher
Darlington Borough Council



*"It certainly wasn't
boring - MAPS is just like
the Facebook site I use
at home"*

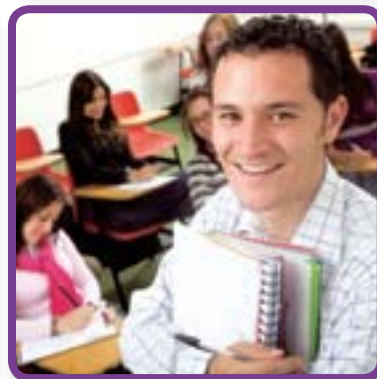

MAPS 3 fully supports an increasing range of **qualifications**, including the new **Diplomas**, from:

What is MAPS 3?



MAPS 3 is a secure and reliable online work-space and e-portfolio that is easy to set-up and use. MAPS 3 is entirely web-based and so is easily available anytime, anywhere, ensuring seamless integration with the lives of busy teachers and students.

Students find the familiar interface - based on popular social networking sites - immediately accessible. The content of their portfolio is controlled by them, and they can transfer it between any educational institution or workplace.

Teachers can monitor their students' progress, assigning tasks, annotating, marking and assessing their work against qualification objectives and mark schemes.

Managers can analyse performance data, standardise assessments and develop parental involvement.



Dear *Teacher*,

MAPS 3 has been several years in development with input from a range of awarding bodies, government organisations, Goldsmiths, University of London and in particular teachers like yourself who have been frustrated by the tools that have been available to date.

Your Learning Platform may lack really good tools for enabling authentic assessment. MAPS 3 provides these tools, giving you and your students an intuitive way to deliver, manage, assess and verify student work in all subject areas. Best of all, MAPS 3 is a complete, easy-to-use package that can be set-up in minutes and seamlessly integrated into your Learning Platform!

Making Assessment for Learning (AfL) and Assessing Pupils' Progress (APP) simple
Everyone agrees that Assessment for Learning and APP are good ideas. MAPS 3 provides powerful assessment tools that focus on maximising the effectiveness of AfL, APP, live controlled assessments and intuitive on-screen marking of digital work.

Marking and annotating digital files produced by your students has always been difficult, with many teachers resorting to printing out the work and marking it with a pen. MAPS 3 now provides an intuitive yet simple answer, converting your student evidence into Flash files with one click, so that you can then mark and annotate the work using drag and drop technologies!

Awarding Bodies

We've been working with awarding bodies across the country for a number of years now, including AQA, Edexcel, OCR and SQA. This now means that for a range of qualifications many of the assessment criteria are built into the system already. For some qualifications you can even electronically submit student coursework and marks directly to the awarding body, saving time, money and paper!

LiveAssess dramatically improves teacher assessment

Our new LiveAssess functionality means that you can create assessment activities that assess students regularly using mind-mapping tools, an image editor and video capture tools to record the story of students' learning. Developed over several years with Professor Richard Kimbell of Goldsmiths, University of London, research has shown this approach to dramatically improve the validity of teacher assessments.

Karim Derrick

Karim Derrick

Matt Wingfield

Matt Wingfield



Create and reflect...



Students record progress and capability by telling the story of their learning in an online journal. They can create text, upload digital photographs, capture audio and video or upload computer files (e.g. Word, Excel) created on any digital device - a desktop or laptop PC, a mobile phone, etc. They can then map this evidence to assessment activities that have been assigned to them.

Students create their learner diaries just like blogs, linking to assessment tasks that have been assigned to them.

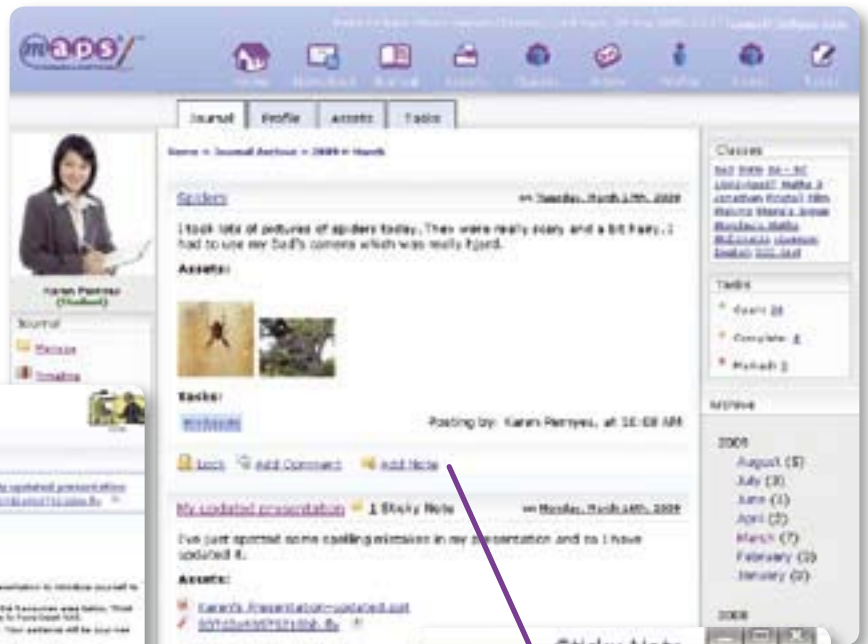

Tasks are set by teachers and assigned to students. Supporting multimedia resources, including SCORM packages, can be uploaded onto the tasks for students to access.

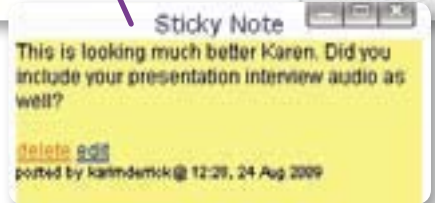

Comments can be easily added to a student's journal.

Track and feedback...

MAPS 3 makes monitoring the progress of students easy. Class summary screens provide an instant overview of progress. Comments and suggestions can be quickly added to a student's journal entries. Students can self-assess against assessment criteria. Completed student work can be locked and referenced to more than one assessment scheme including APP and examination coursework schemes.

Class overview

Name: [Name]
Year group: [Year]
Teacher: [Teacher]
Subject: [Subject]
Total students: [Total]
Present from students: [Present]

Students (6)	Name	Start	Complete	Marked	Assessed	Spots
1	[Name]	20	2	2	2	2
2	[Name]	20	2	2	2	2
3	[Name]	20	2	2	2	2
4	[Name]	20	2	2	2	2
5	[Name]	20	2	2	2	2
6	[Name]	20	2	2	2	2

Review progress of students towards attainment in different components of a qualification.

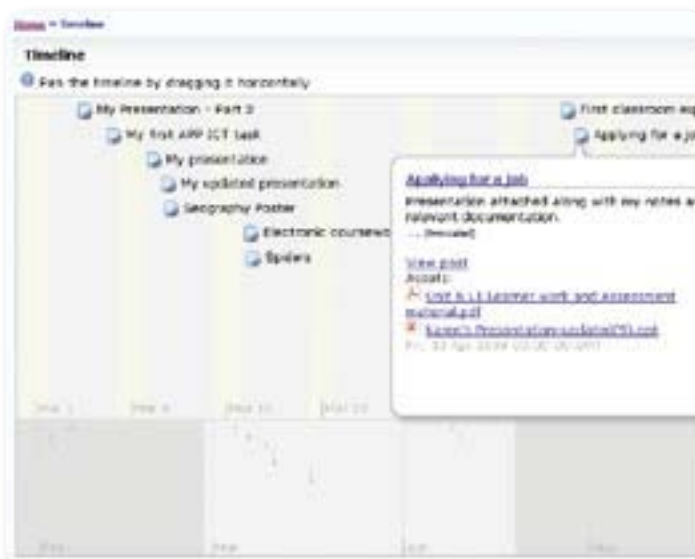

Overall progress can be quickly reviewed using the timeline.

Students and teachers comment on evidence linked to assessment criteria creating dialogue around the learning.



Teachers can access each student's journal directly.

...Saves time

LiveAssess

LiveAssess has been developed over several years in partnership with Goldsmiths, University of London, as part of the 'e-scape' project. The LiveAssess suite of tools includes a graphics package, mind mapping tool and video/audio/image software to help you capture student creativity, problem solving and collaborative skills as they happen.



2

Students use the built-in tools to evidence their learning at the times determined by the task.

1

Create Live Assess tasks using the lesson timeline tool.

Set-up and manage student collaboration groups for the task.

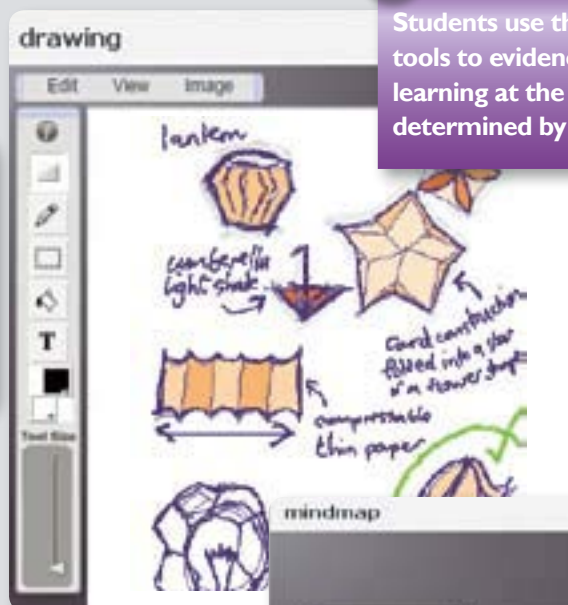
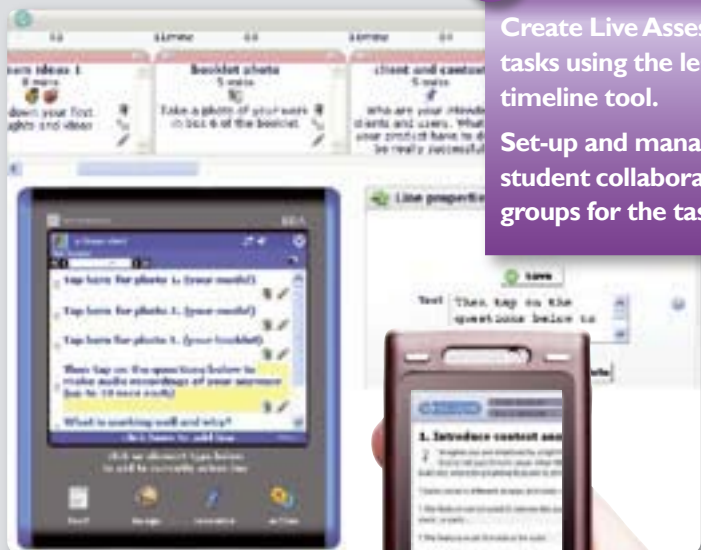

Students use the web-based software to capture and record evidence as it develops using the range of included tools - text, drawing, mindmaps, photo, video and sound.

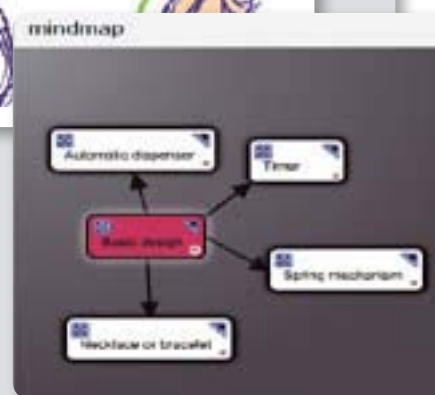

Students can add evidence to their portfolios even when they are away from a computer by sending text pictures, videos, audio files, via MMS text from any mobile phone - ideal for field trips or work placements.



3

The final portfolio describes the story of the students' learning in words, pictures, audio and video.

Collaborative elements show student feedback on each other's work

Click to see photo at full size

Hover over text to expand

Click to play back audio

Click to view video

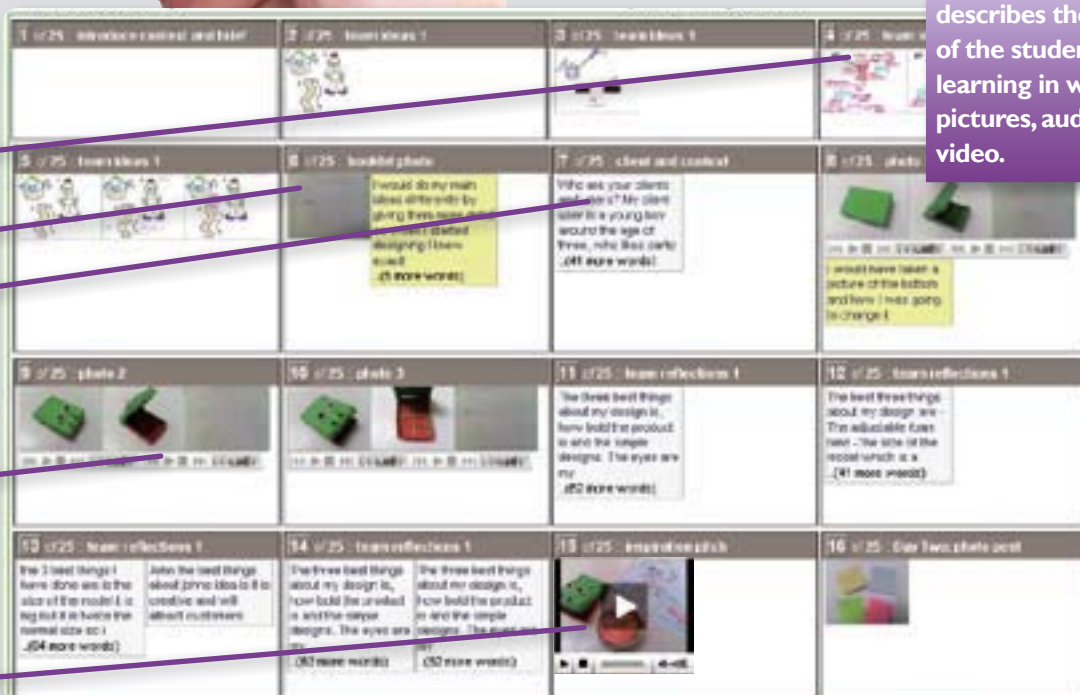

LiveAssess portfolio presents a holistic, storyboard view that describes the evolution of the student's learning over time. Ideal for supporting Assessment for Learning and for capturing evidence of softer skills such as creativity, problem solving and collaboration.

...Saves money

Review and assess...



At the end of an assessment activity all of the evidence can be formally assessed against internal or external assessment criteria using the revolutionary Red Pen Tool. APP criteria can also be tagged against the digital evidence, and centrally tracked to show pupil progression through the AFs and Levels. For qualification related coursework, the evidence and assessment can then be directly submitted to examination boards where this facility has been made available.



APPAssess - tracking pupil progression

Viewing assessment grid for reading

Level	AF1 - 488	AF2 - 508	AF3 - 528	AF4 - 548	AF5 - 568	AF6 - 588	AF7 - 608	Judgement
Level 6								Not set
Level 5								Low
Level 4								High

“APP” (Assessing Pupils’ Progress) criteria can be periodically assessed and monitored using the built in tools. This can be done in retrospect or at any time through the school year.

Introducing the Red Pen Tool

Intuitive on-screen annotation and marking of digital coursework.

The **Red Pen Tool** can be used to facilitate self assessment, peer to peer assessment, teacher assessment and assessment verification/standardisation.

Add audio comments to your students’ work using a microphone

Use the highlighter tool just like a highlighter pen

Create longer notes, hover over the pin to read the full text

Create and position your annotations

Drag and drop assessment objectives onto the exact place they are evidenced within the work

Using Red Pen, students can self-assess their work, and teachers can add annotations and highlight words. Each user is assigned their own annotation colour on a different transparent layer that sits over the original work to making it simple to track comments and feedback from different users. Assessment objectives/criteria are displayed directly below the work. These can be dragged and dropped to show exactly where they are evidenced.

...Improves results

What you get



- A **fully managed online solution**, set up and hosted by TAG.
- **200MB of space** and a **customisable interface** for every user.
- The ability to **assign tasks online** to individuals, groups or whole classes.
- Online tools **to add learning support resources**, including SCORM content and standard base quizzes.
- The ability to **link MAPS 3 portfolios to mobile devices** to facilitate the capture of multimedia evidence when students are on work-placement, field trip or any situation in which access to a PC is limited.
- The brand new **reflective learner Journal** enabling students to keep an iterative, real-time record of their achievements and project milestones.
- The revolutionary **Red Pen Tool** to annotate, mark and assess student work online.
- The **centralised management and reporting** of students' work and progress.
- Simple and secure **Parents' Newsfeed** function to engage parents in the learning and monitoring process.
- Direct and secure **online coursework submissions** to participating awarding bodies.

Integration

MAPS 3 is web-services based, so MAPS 3 assessment modules can be fully integrated into any learning platform to provide a single learning and assessment environment.

MAPS 3 is fully Shibboleth and OpenID compliant. This means that teachers and students need only sign-in once to a range of school learning platforms including Moodle.

Pricing

Both MAPS 3 as a complete system and the individual assessment modules like Red Pen Tool and LiveAssess are available for purchase via flexible school-wide subscriptions for one, two or more years, starting from as little as £105 ex-VAT for the Red Pen Tool and £350 ex-VAT for the complete MAPS 3 system, per year for the whole school.

For example, purchasing the entire MAPS 3 solution, a school with 1,250 students would pay just £1.28 per student per year. A school with 740 students would pay just £1.32 per student per year - a cost easily recovered through savings on printing alone.

Purchase a subscription for two or more years and this can be treated as Capital Expenditure and thus purchased with your Harnessing Technology Grant.

Further information



To learn more about MAPS 3, Red Pen Tool, LiveAssess, APP Assess or any aspect of the solution and arrange a demonstration please contact the sales department on 01474 357 350 or email sales@mapsassessment.com

